

Whernside Crescent



Attractive, and cared for, three bedroom property

Favoured 'Sober Hall' area of Ingleby Barwick

Widened drive, garage and rear garden which enjoys a sunny aspect

Spacious open-plan lounge/diner

Master bedroom with robes and en-suite

£179,995



Multi-Award Wining



Situated within the sought after 'Sober Hall' area of Ingleby Barwick, whilst enjoying a good position, with sunny rear aspect and widened front drive, this cared for three bedroom semi-detached property certainly merits early inspection.

Deceptively spacious, the accommodation briefly comprises an entrance hall, generous through-lounge/diner and modern fitted kitchen to the ground floor. The first floor bringing there good bedrooms, 'Master' with robes and en-suite, separate family bathroom.

GROUND FLOOR

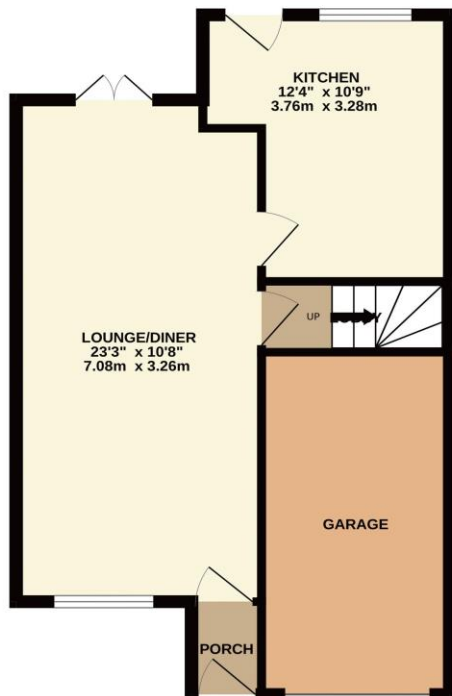

1ST FLOOR

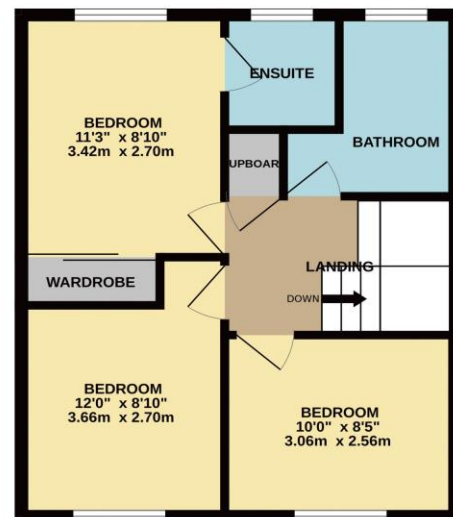

Whilst every attempt has been made to ensure the accuracy of the floorplan contained here, measurements of doors, windows, rooms and any other items are approximate and no responsibility is taken for any error, omission or mis-statement. This plan is for illustrative purposes only and should be used as such by any prospective purchaser. The services, systems and appliances shown have not been tested and no guarantee as to their operability or efficiency can be given.
Made with Metropix ©2023



“The Ingleby Barwick Experts”



Tenure: Freehold

Council Tax Band: C



AGENTS NOTE: Every care has been taken with the preparation of these details, but they are for general guidance only. Measurements and dimensions are approximate, and any fixtures or fittings shown in photography does not infer that they are to be included within the sale. The agent has not tested any appliances or supplies and professional verification of these should be sought prior to purchase if required. These particulars do not constitute a contract or part of a contract.